

WILLIAMS PARKWAY

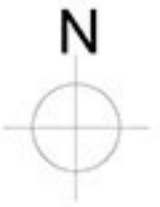

**PROPOSED SUMMERDALE CENTRE  
COMMERCIAL DEVELOPMENT**  
JAMES POTTER ROAD AND  
WILLIAMS PARKWAY,  
BRAMPTON, ONTARIO

JAMES POTTER ROAD

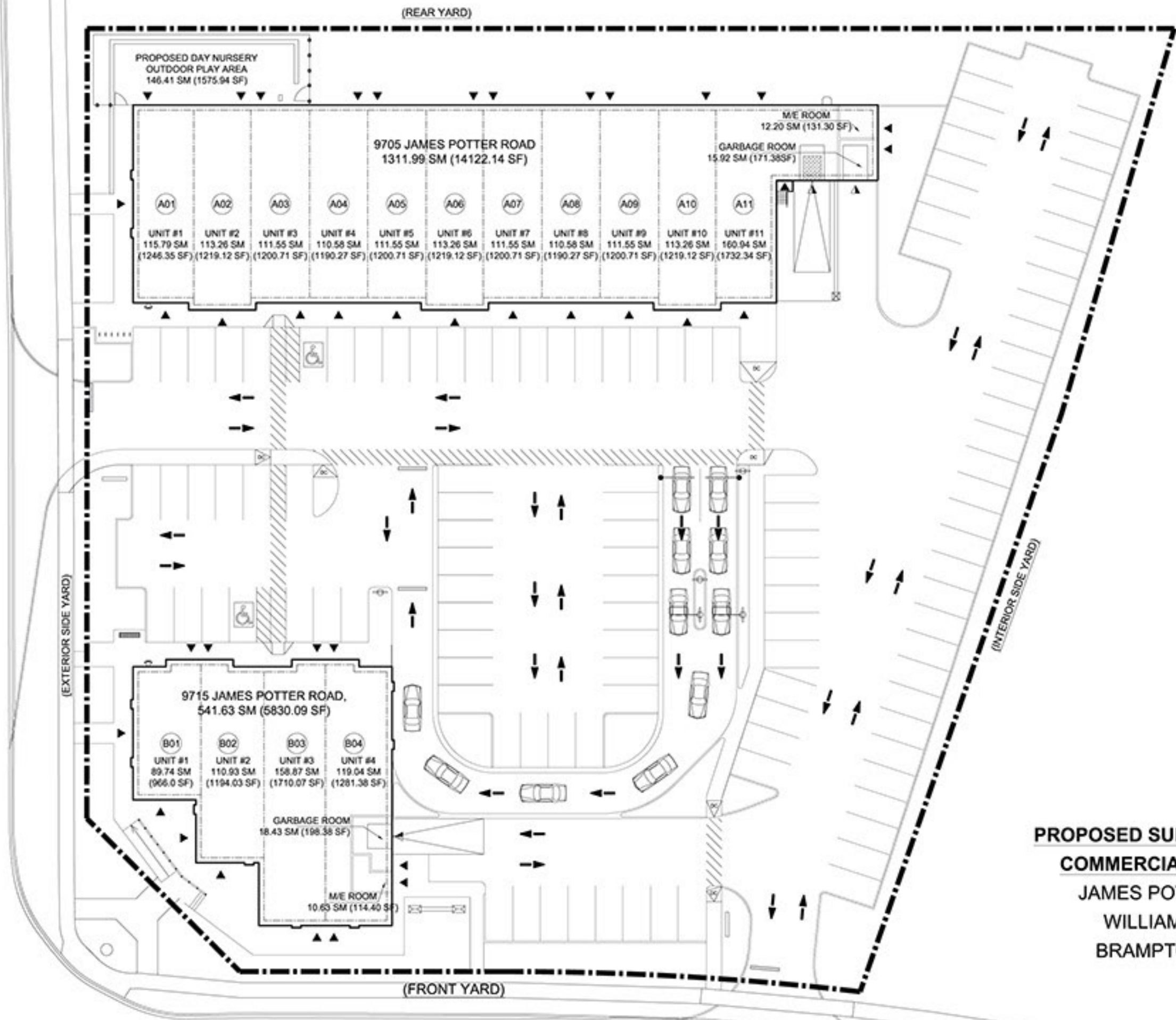

ALL AREAS AND DIMENSIONS ARE APPROXIMATE AND SUBJECT TO CHANGE  
RELATIVE TO FINAL CONSTRUCTION DRAWINGS.